

SPECIFICATIONS

(Typical values for batteries stored at 20 °C for one year or less)

Nominal Capacity (At 5mA/20 °C/68 °F/2.0V Cut-Off)	16.0 Ah
Open Circuit Voltage (At 20 °C/68 °F)	3.92 V
Nominal Voltage (At 5mA/20 °C/68 °F)	3.90 V
Maximum Continuous Current	230 mA
Operating Temperature Range	-40 ~ 85 °C
Weight	92.5g (3.26 oz)
Anode Surface Area	40 cm ²
Volume	51 cm ³
Diameter (Max)	33.6 mm
Height (Max)	60 mm

DIMENSIONS IN MM

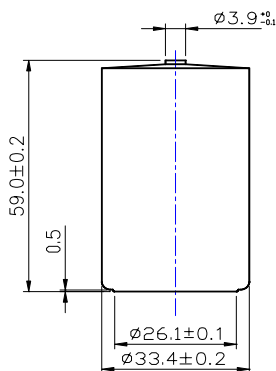

WARNING
Fire, Explosion And Severe Burn Hazard.
Do Not Recharge, Crush, Disassemble,
Heat Above 212°F(100°C), Incinerate
Or Expose Contents To Water

DISCHARGE CHARACTERISTICS AT +20 °C

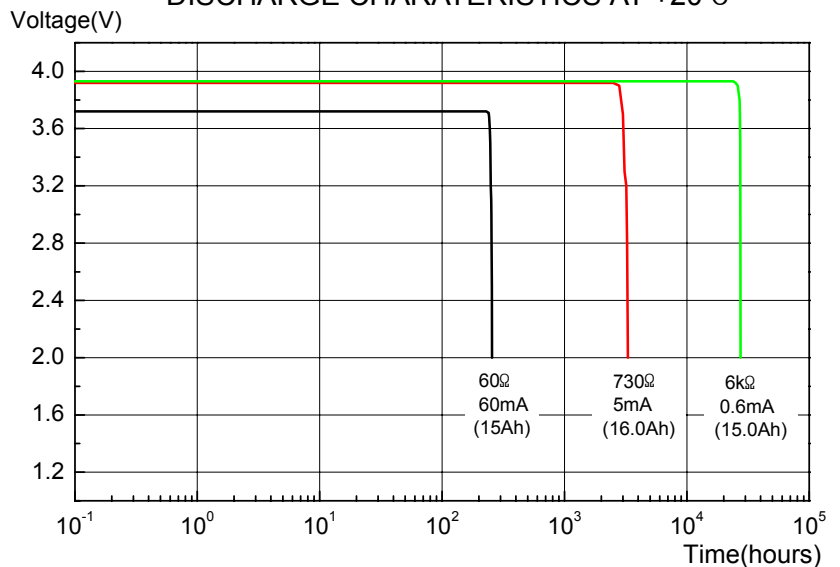

CAPACITY VS. CURRENT

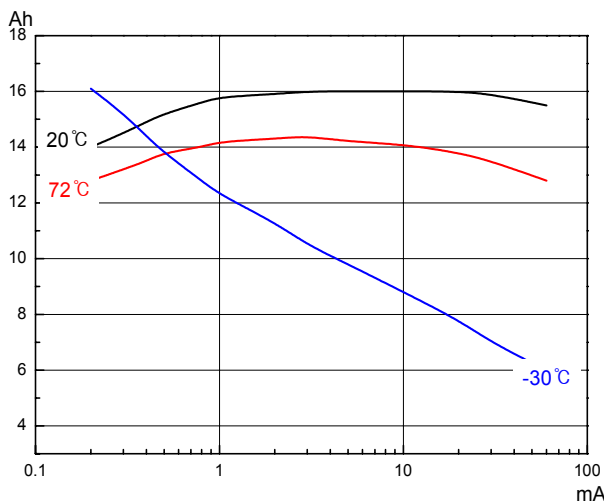

OPERATING VOLTAGE

